

From your mobile device log into Sydney:

Utilize the navigational options at the bottom of your screen. Select Care.

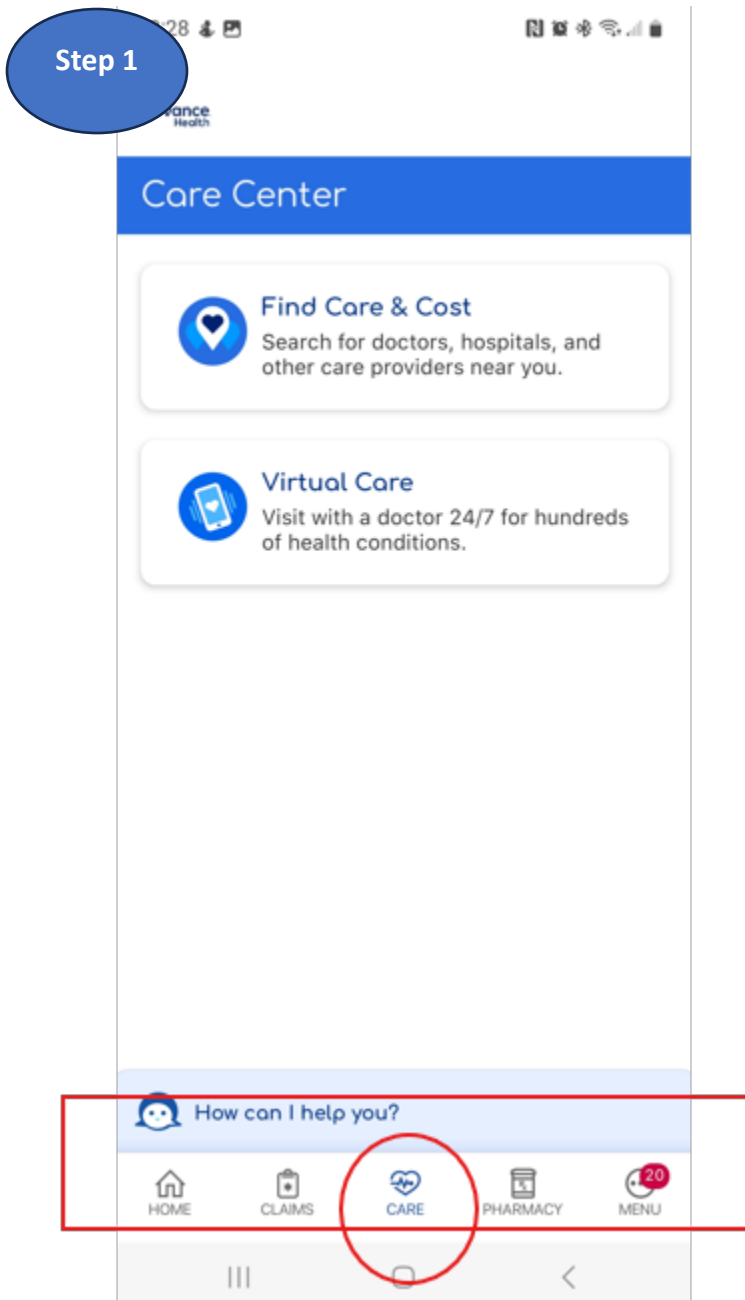

Step 2

Select Find Care & Cost

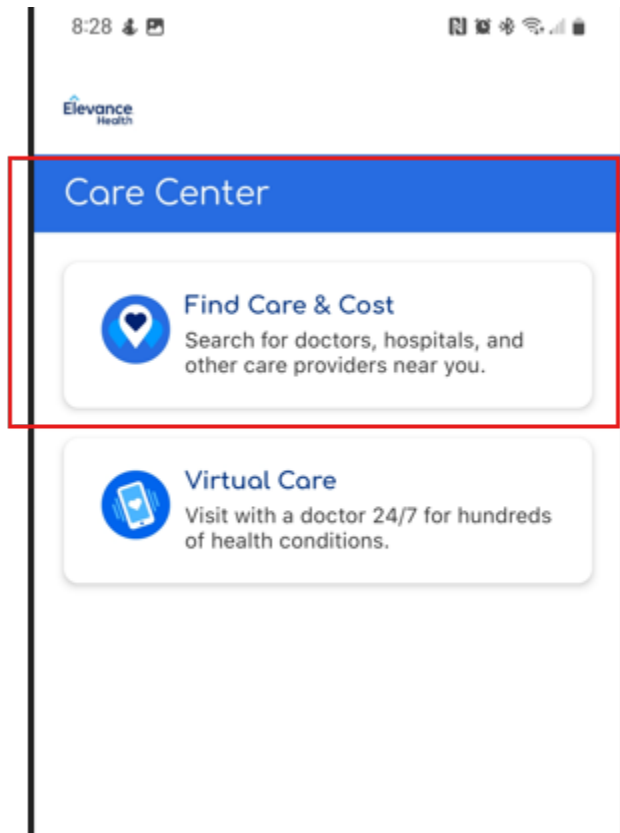

Step 3

Select the family member you are looking to reassign a PCP (Next). Then select into Primary care.

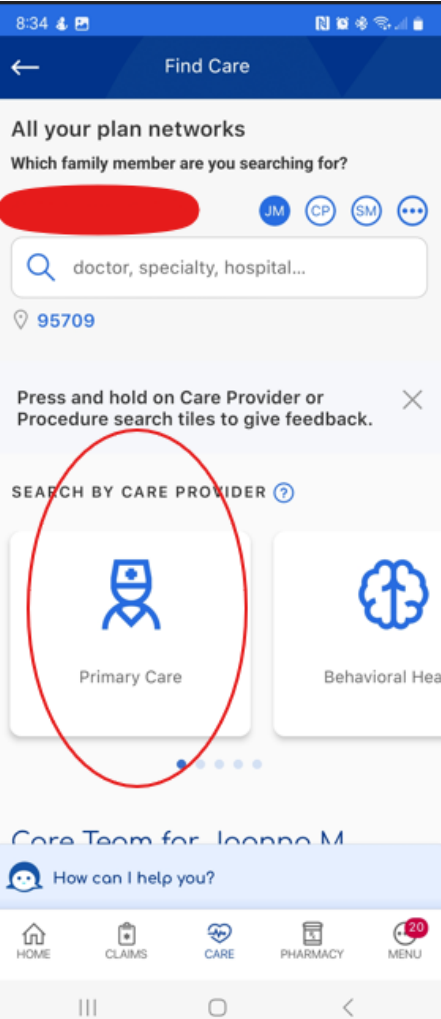
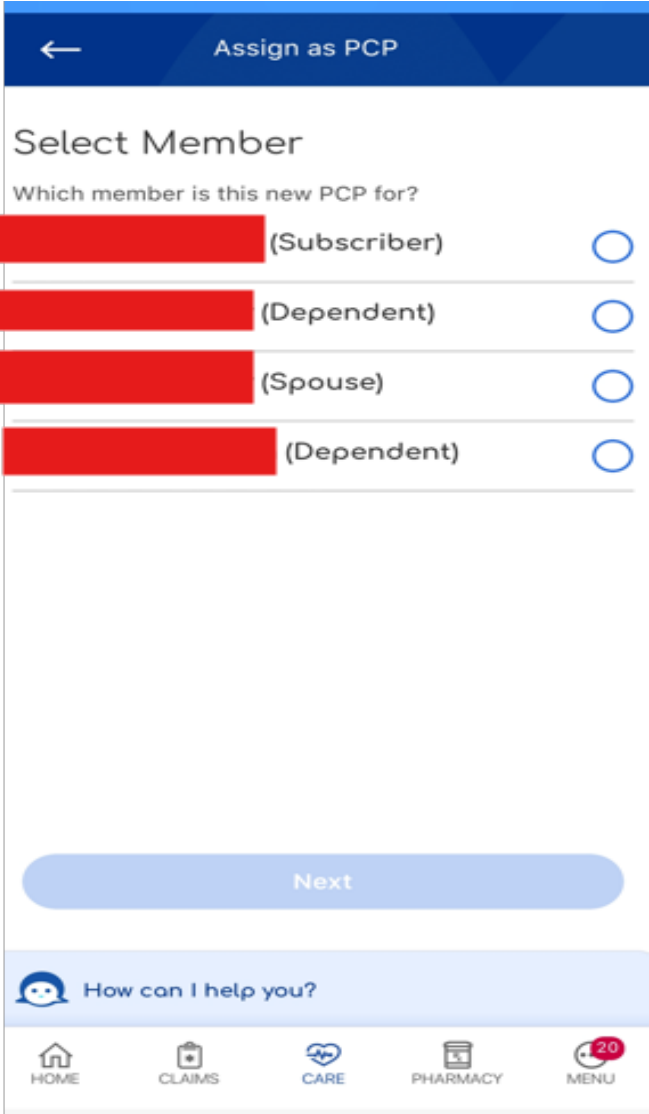

Step 4

Review results and compare care providers. Once you have selected your care provider, select arrow as shown below.

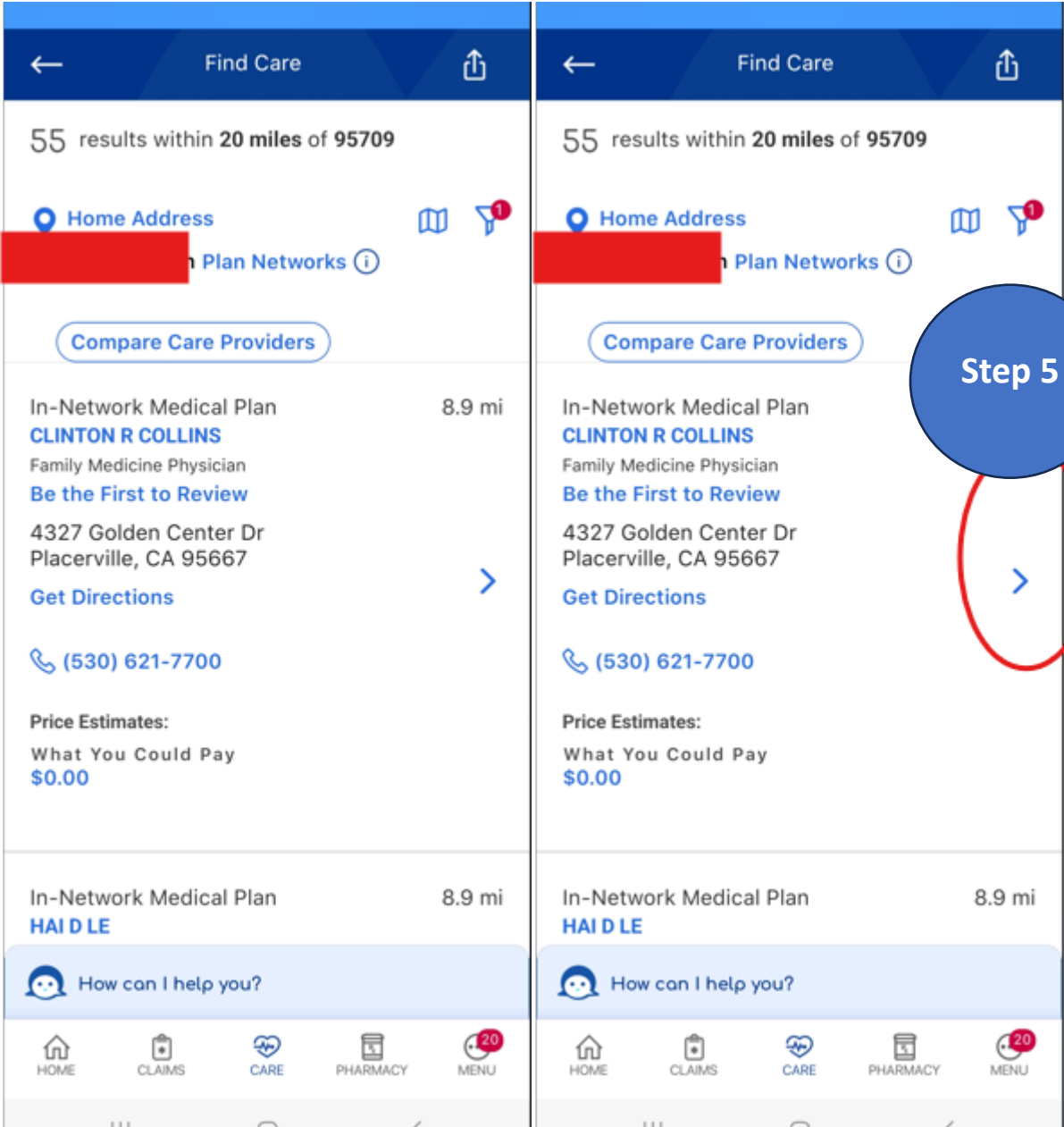

Step 6

Select Assign as a PCP. Review PCP update in the next screen and select NEXT as shown below.

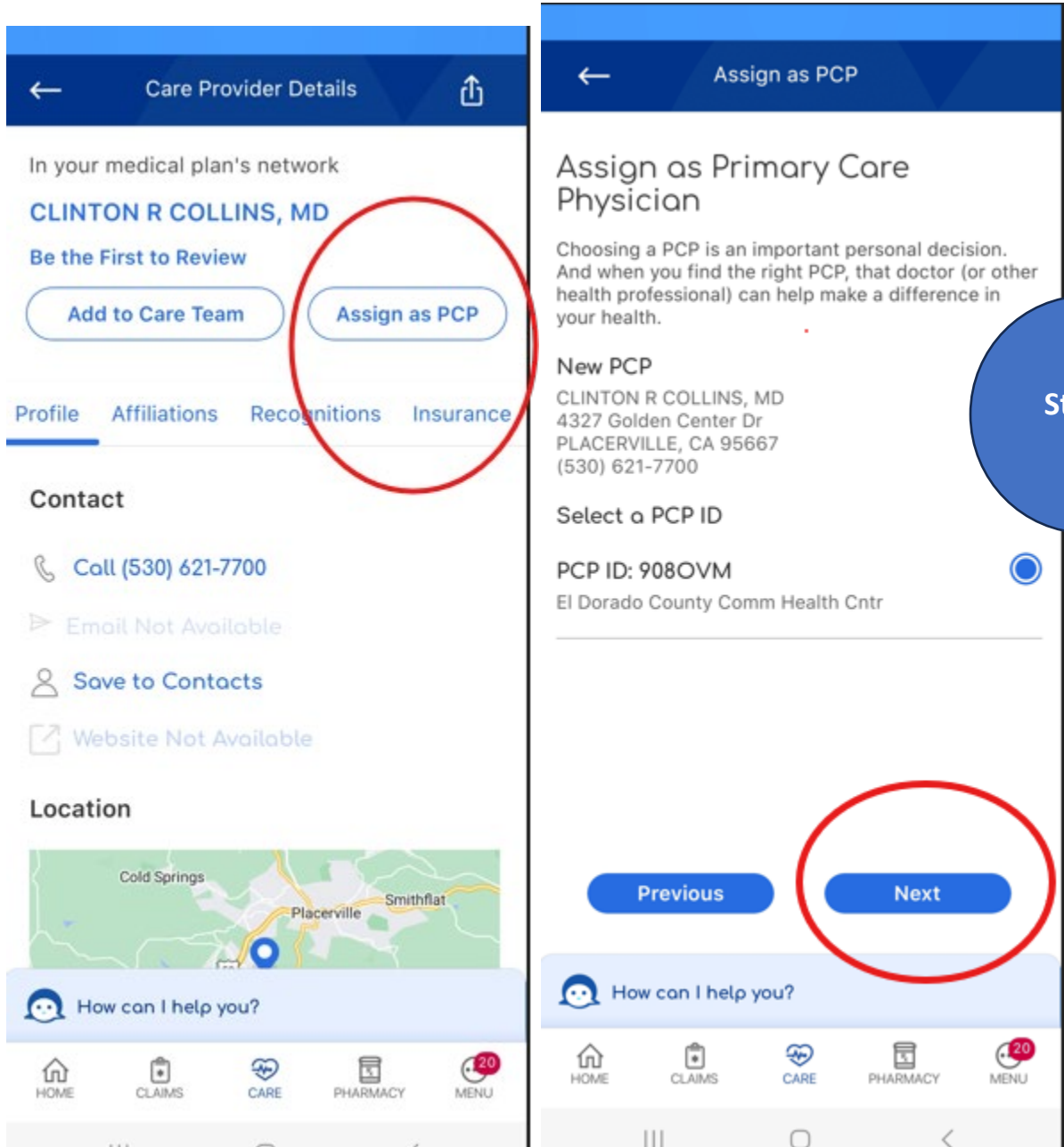

Step 8

Review PCP one final time. After confirming provider, select Assign PCP.

Success Banner should appear to confirm the change has taken place.

← Assign as PCP

Review PCP Update

Review the information below. If you need to edit this information, please use the "Previous" button.

New PCP
CLINTON R COLLINS, MD
4327 Golden Center Dr
PLACERVILLE, CA 95667
(530) 621-7700

PCP ID: 908OVM
El Dorado County Comm Health Cntr

Member
[Redacted] (Subscriber)

Plan
[Redacted]

Previous Assign as PCP

How can I help you?

HOME CLAIMS CARE PHARMACY MENU 20